

1

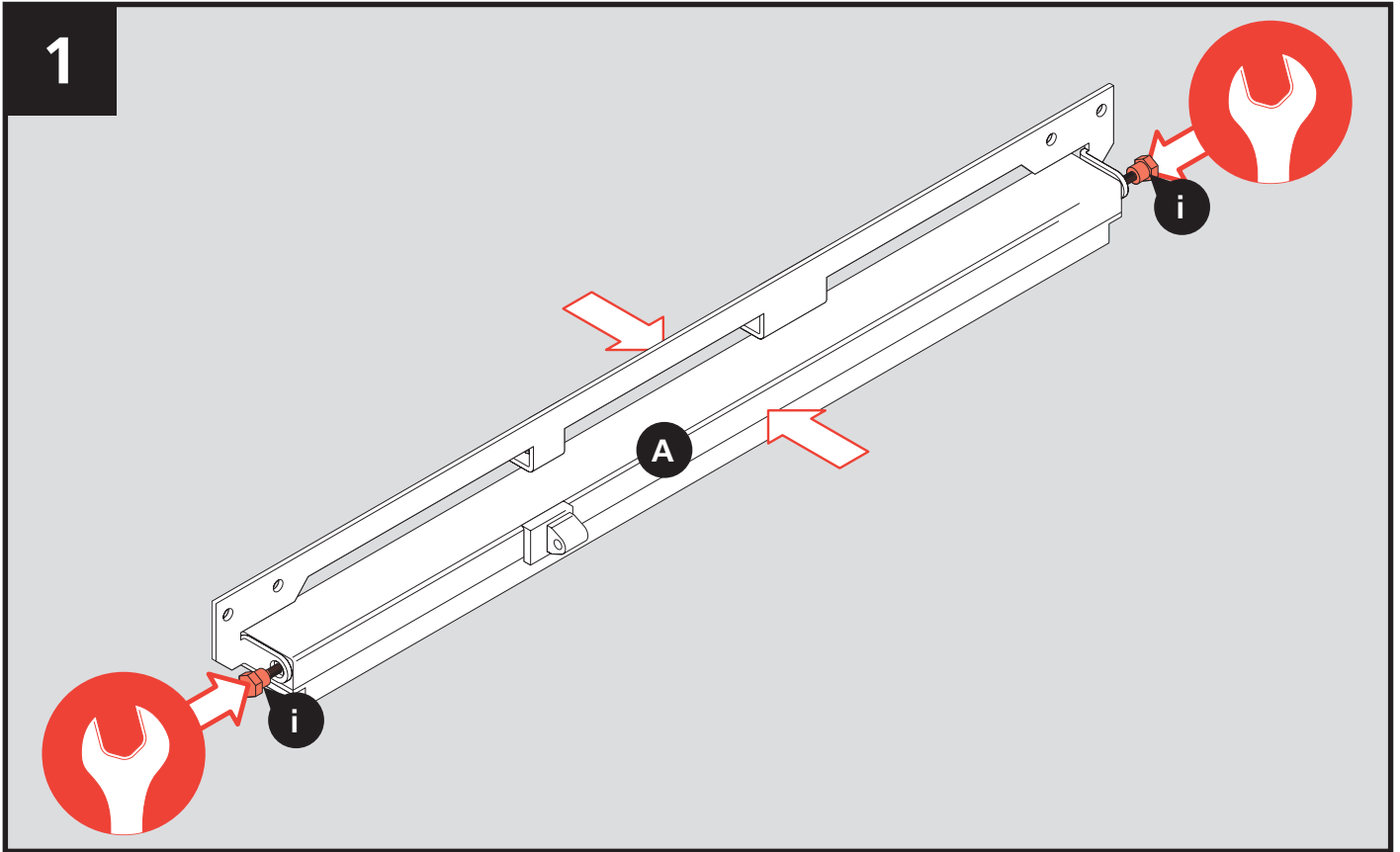

2

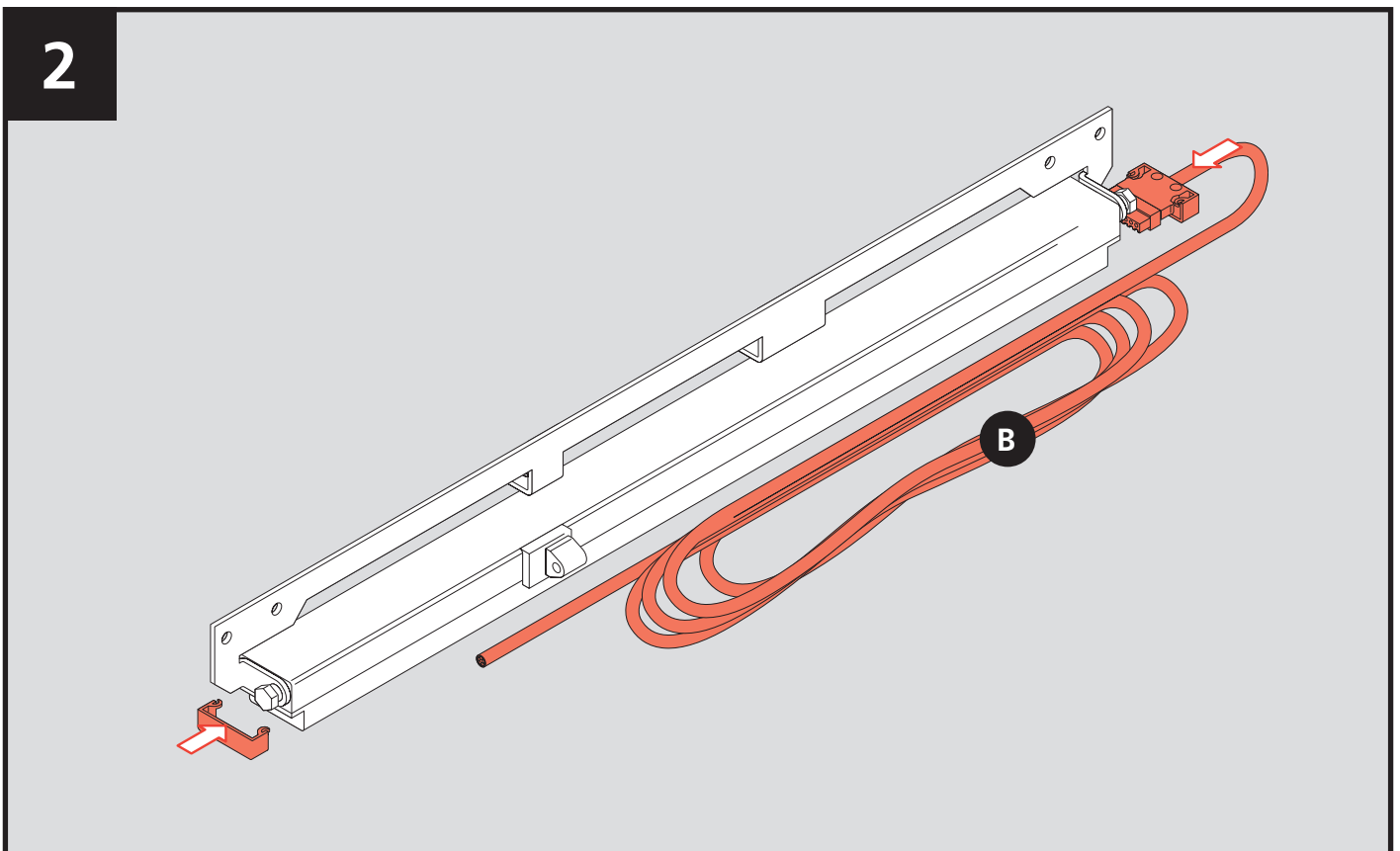

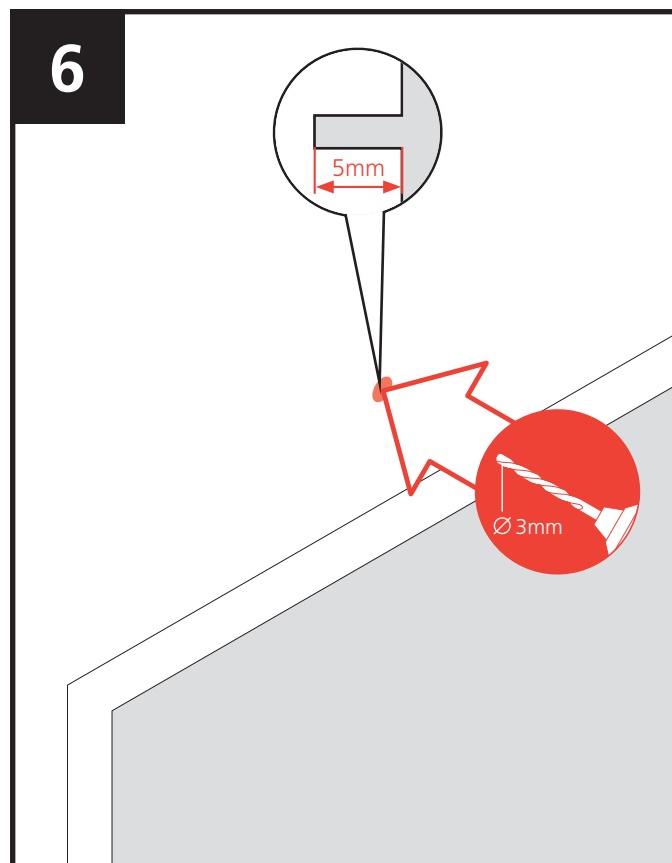
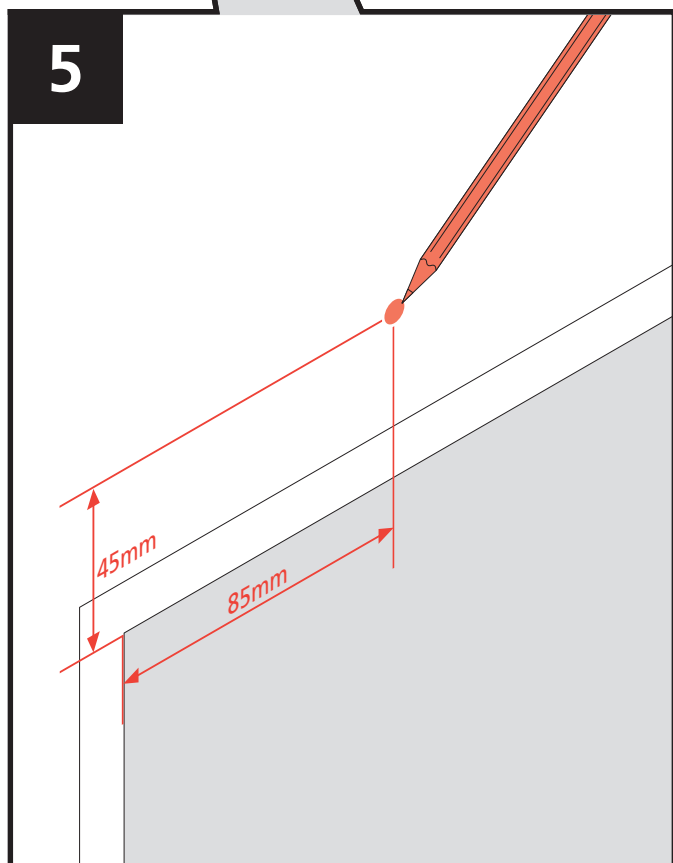
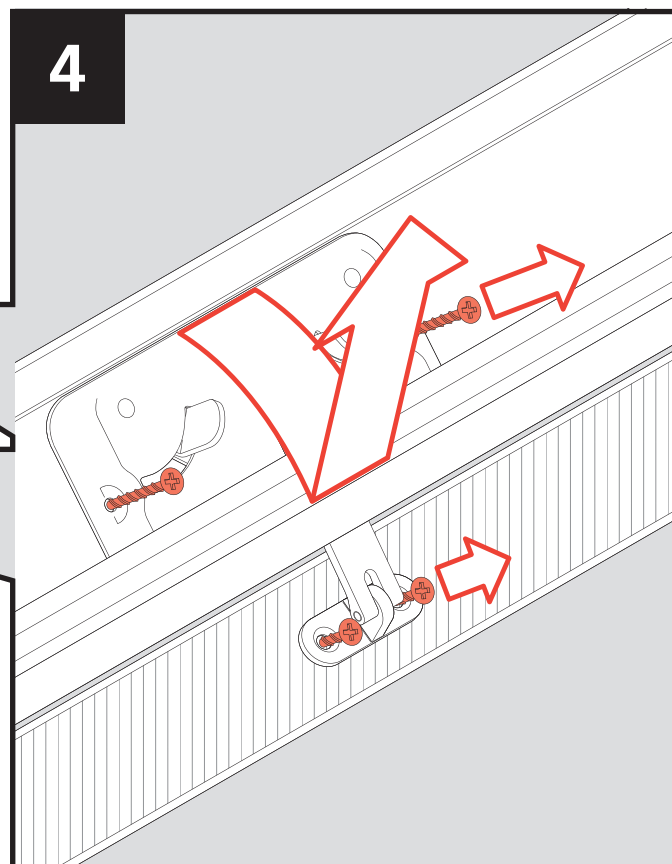
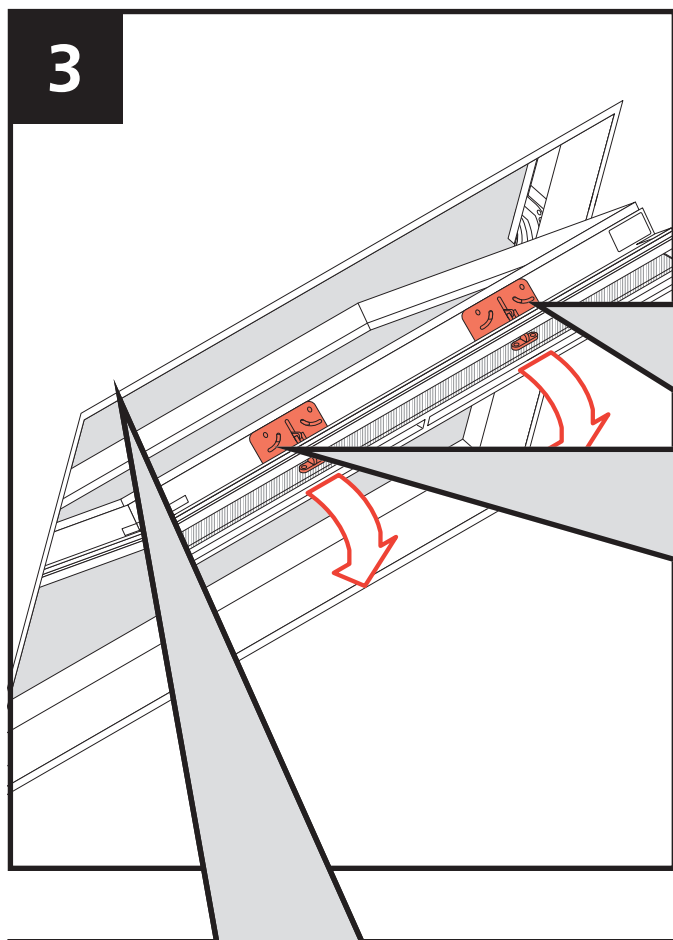

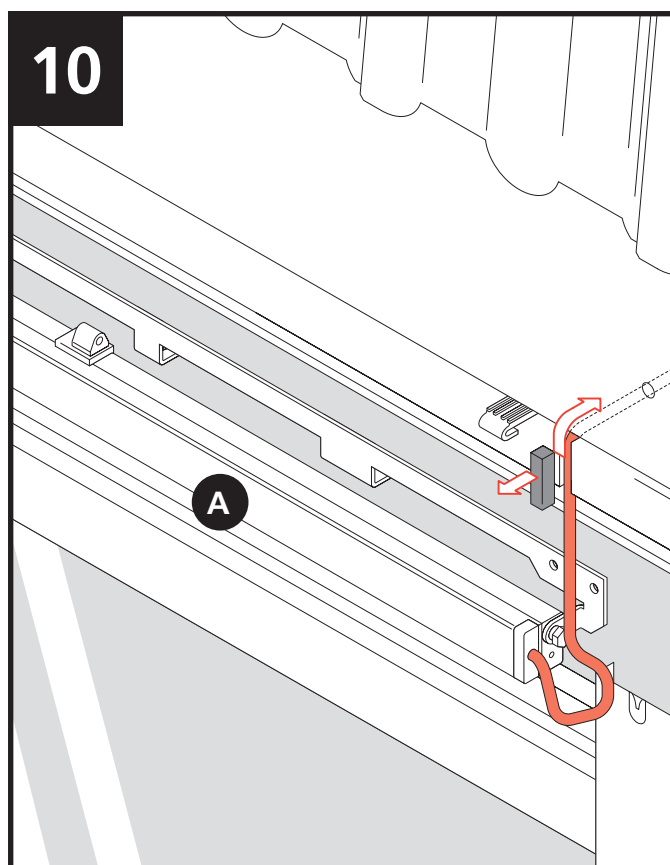
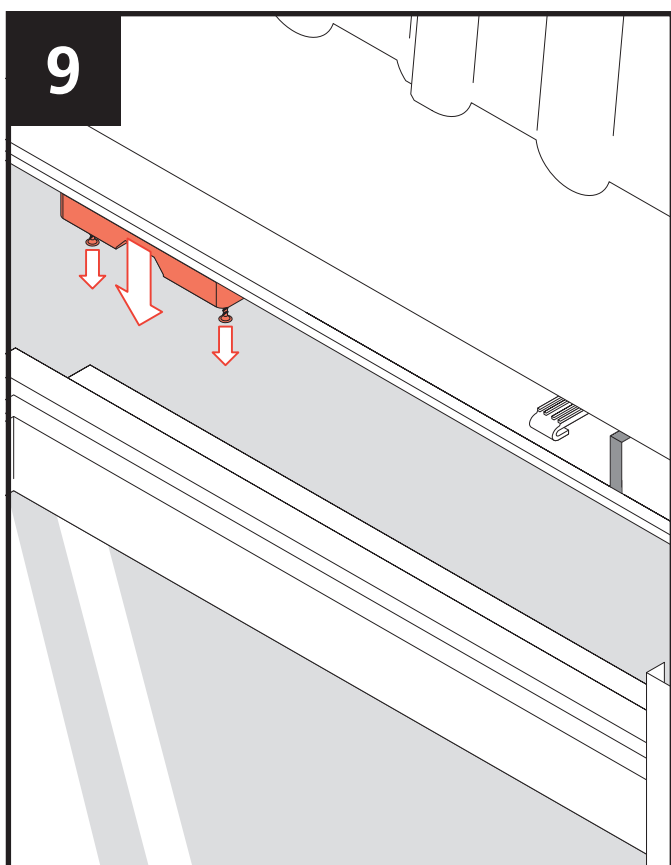
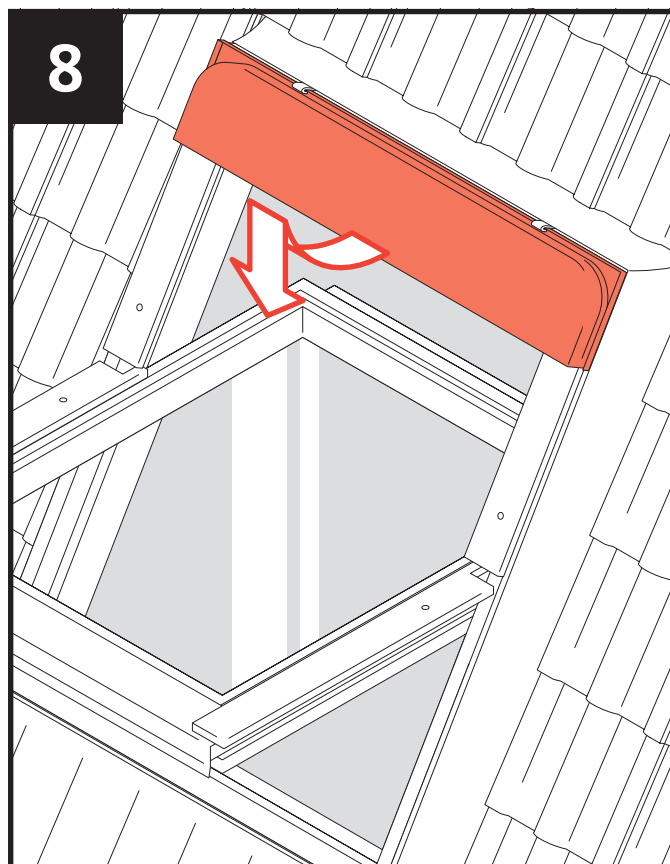
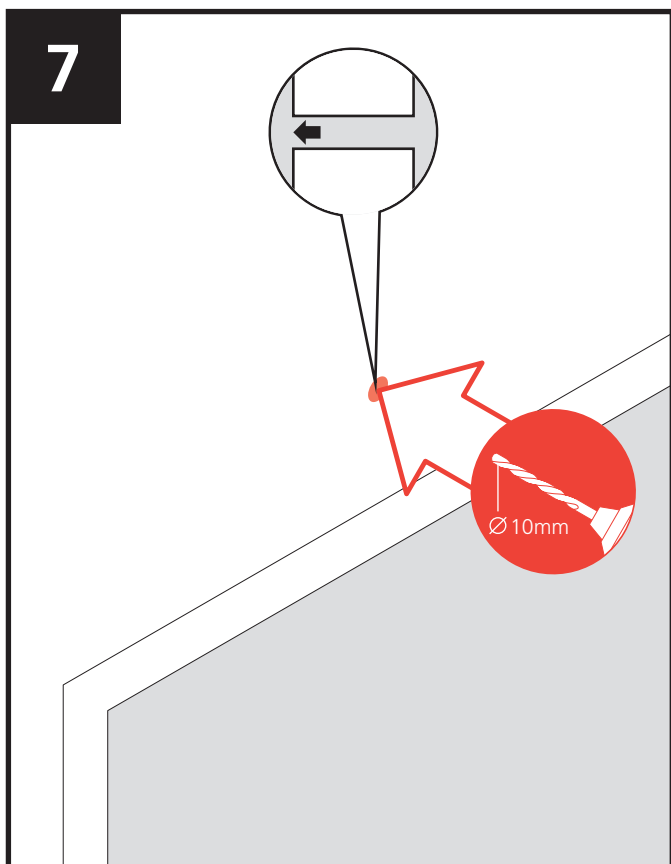

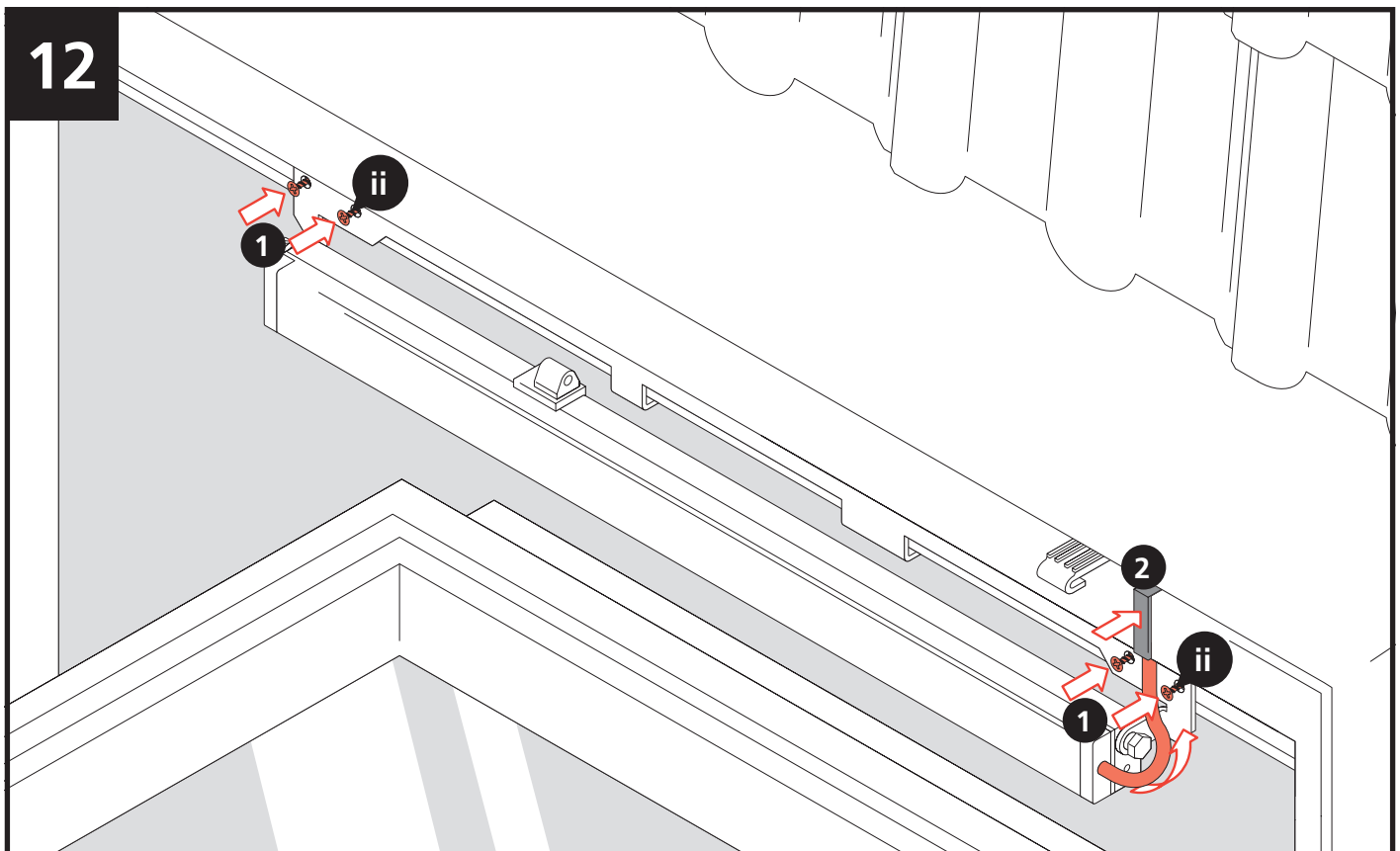
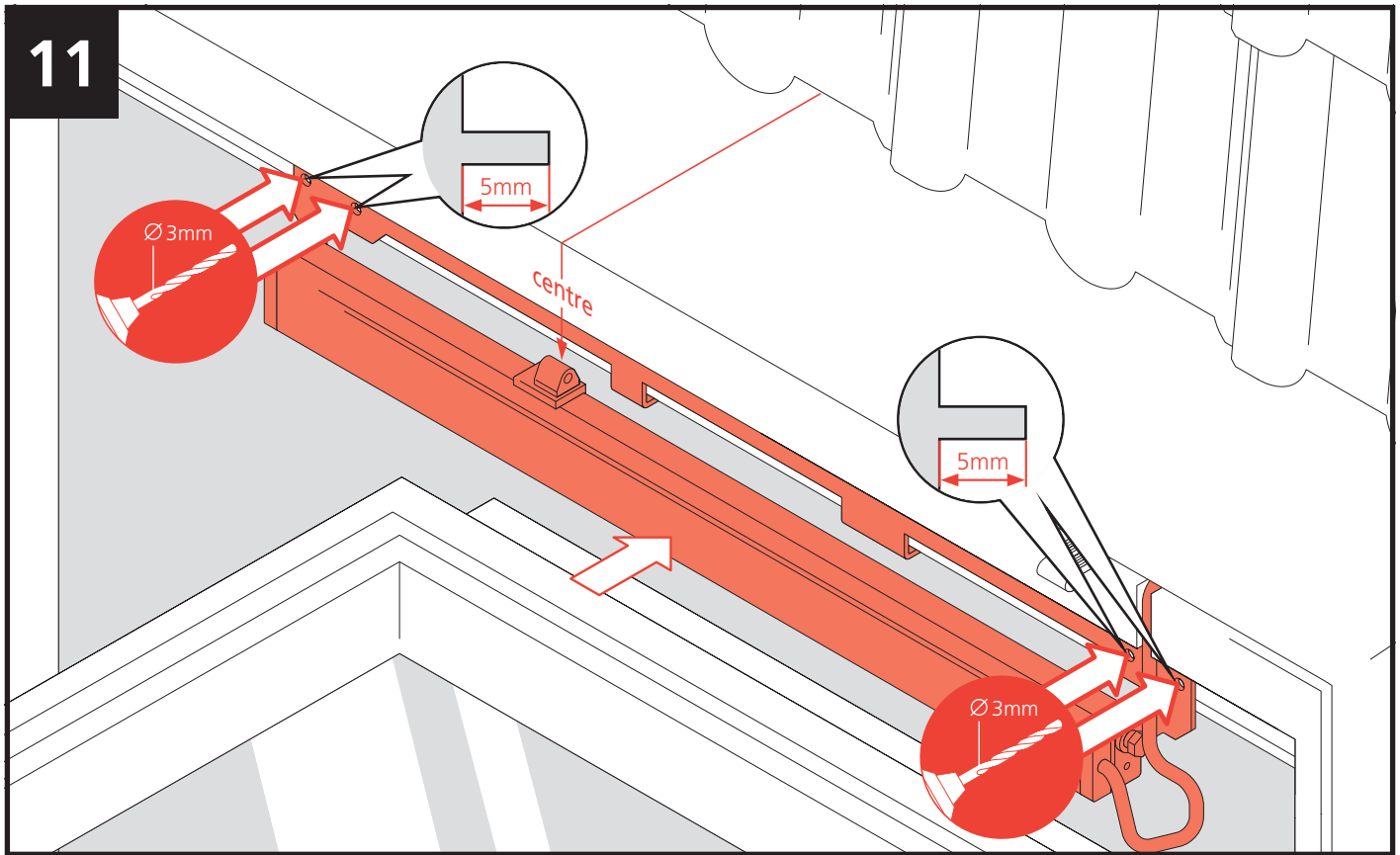

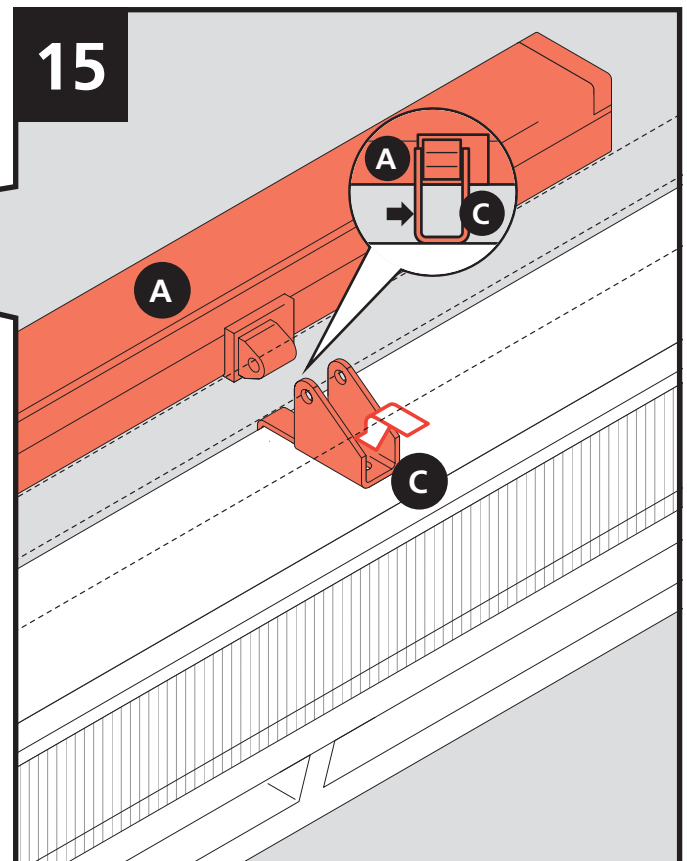
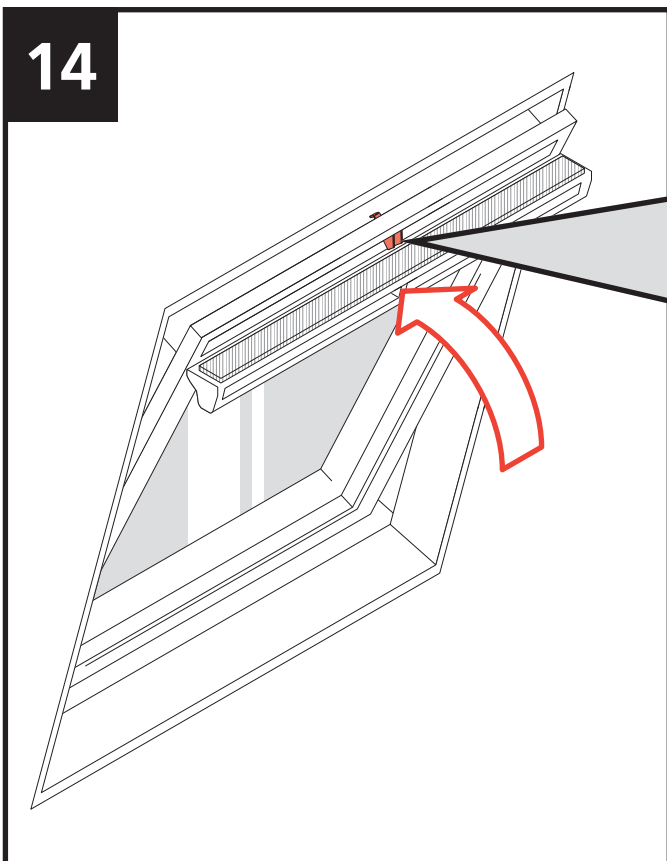
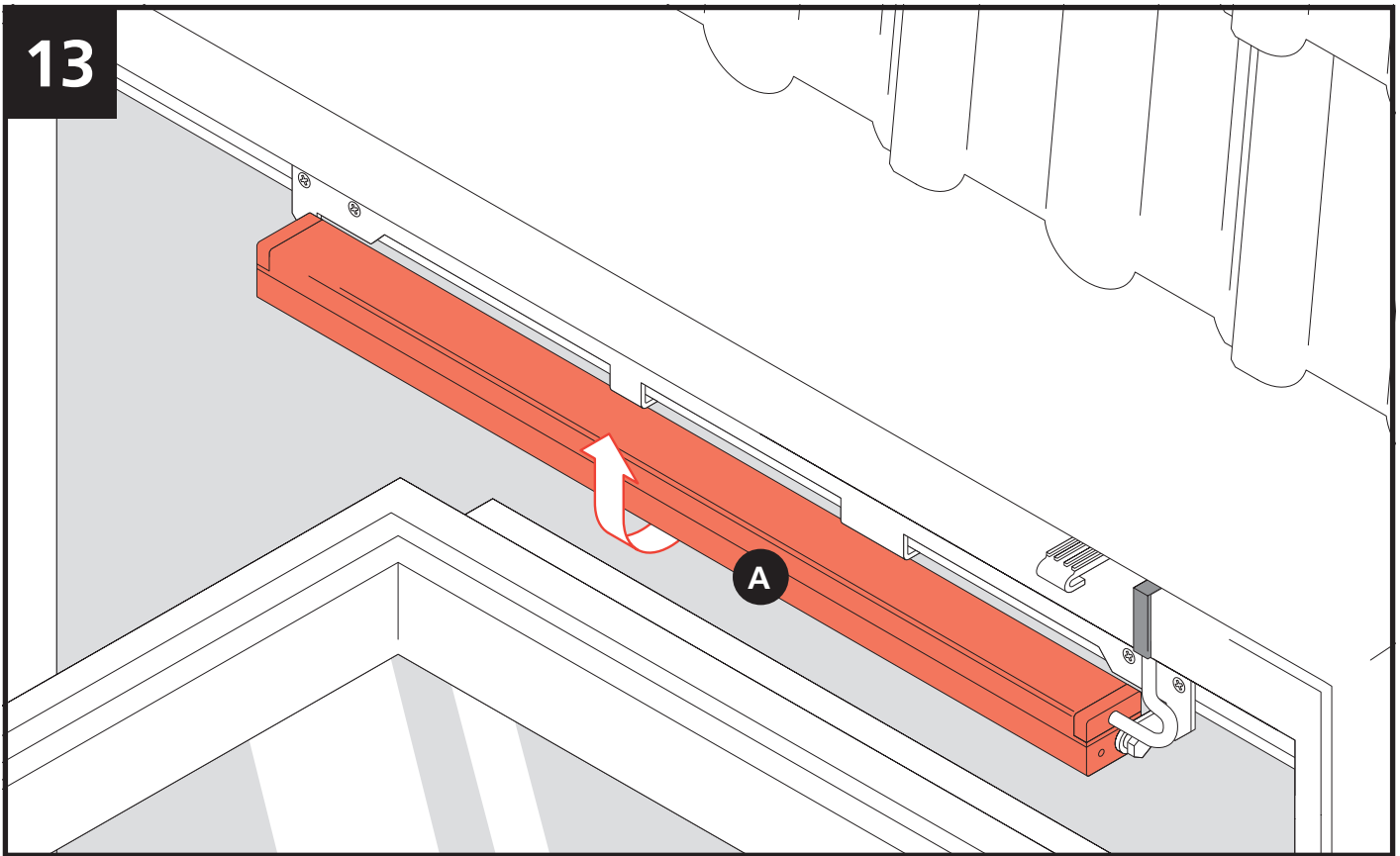

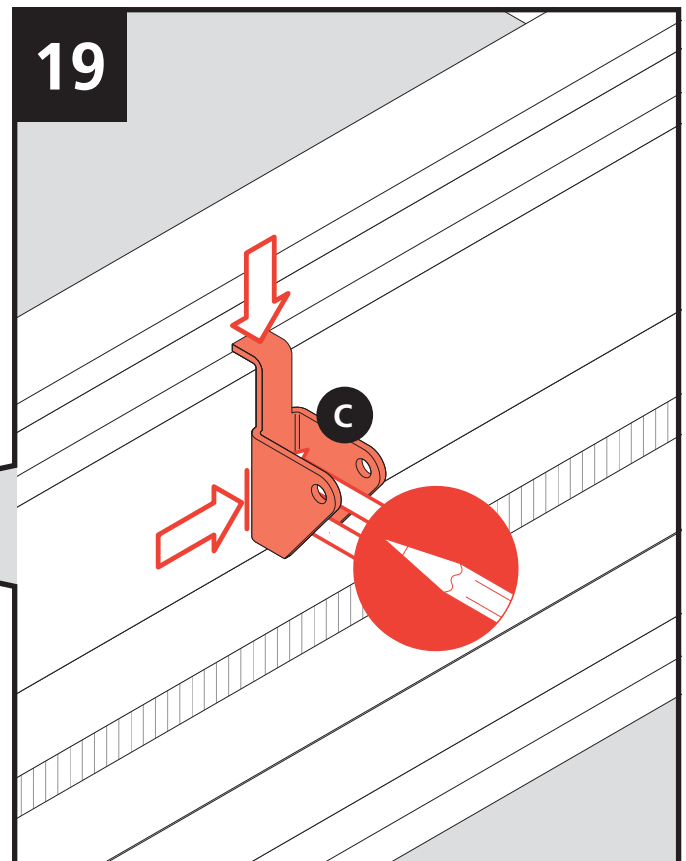
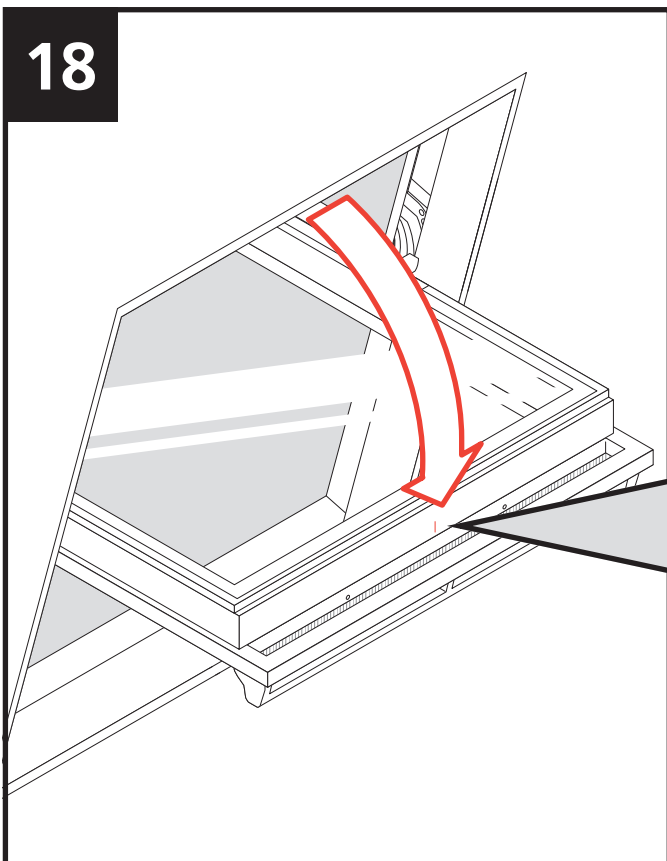
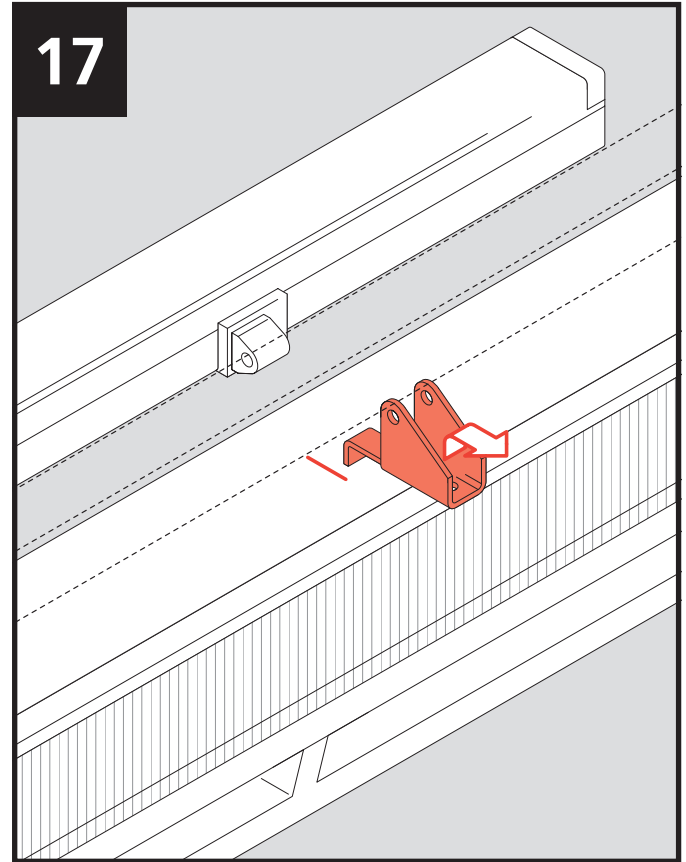
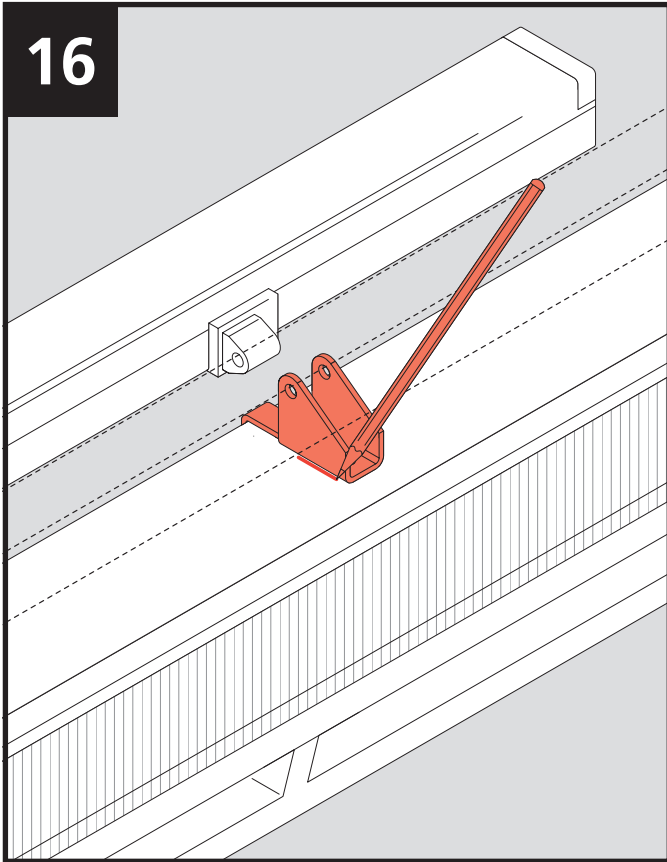

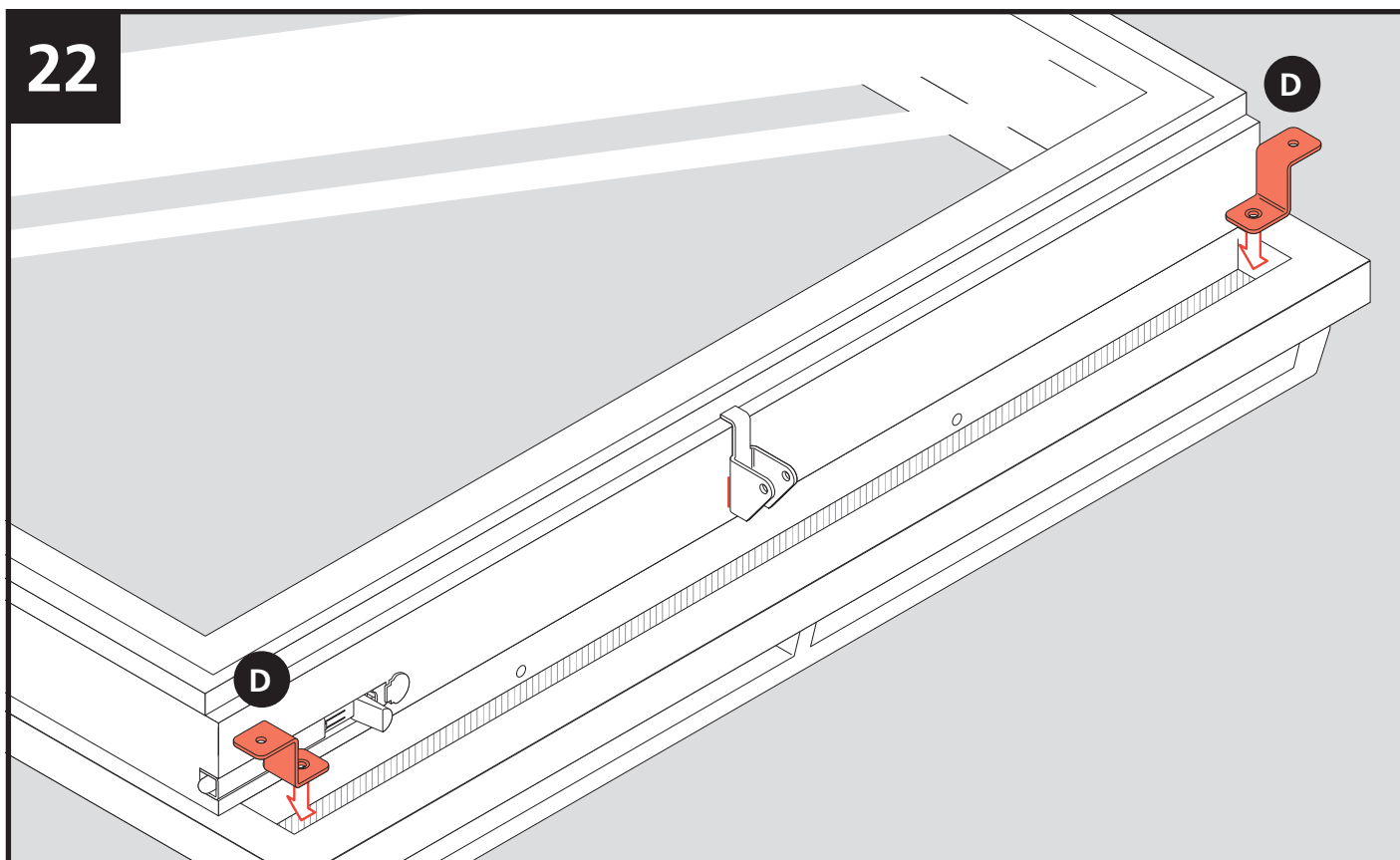
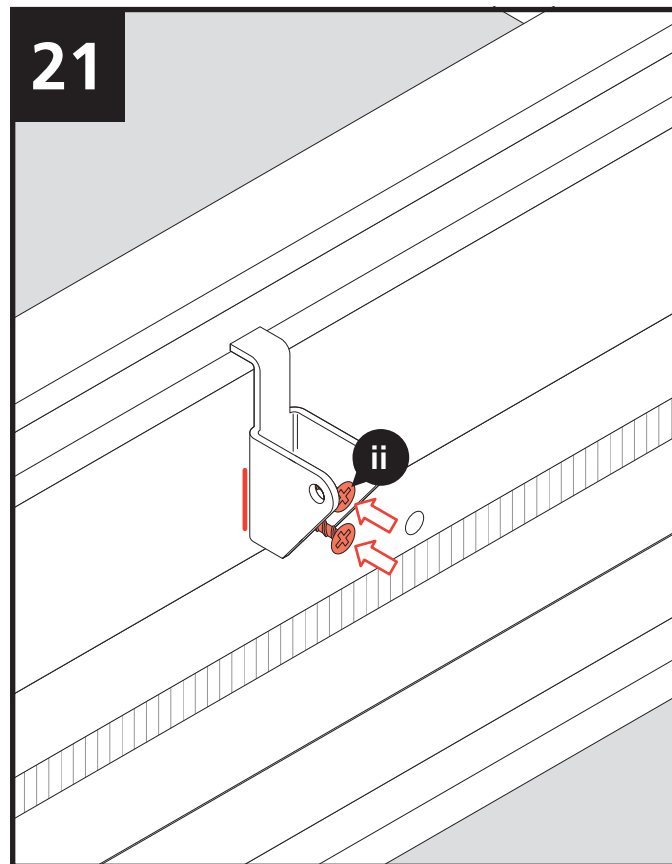
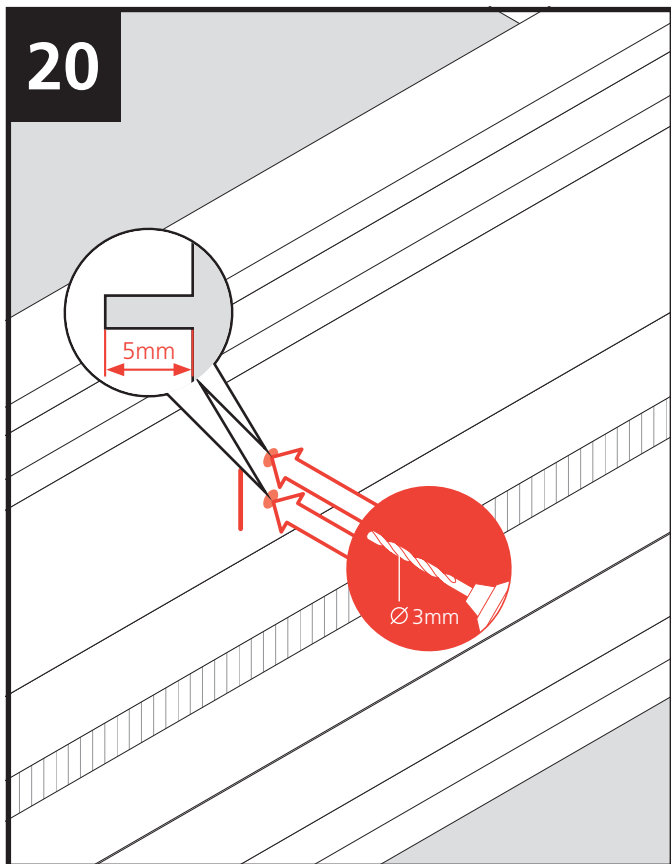



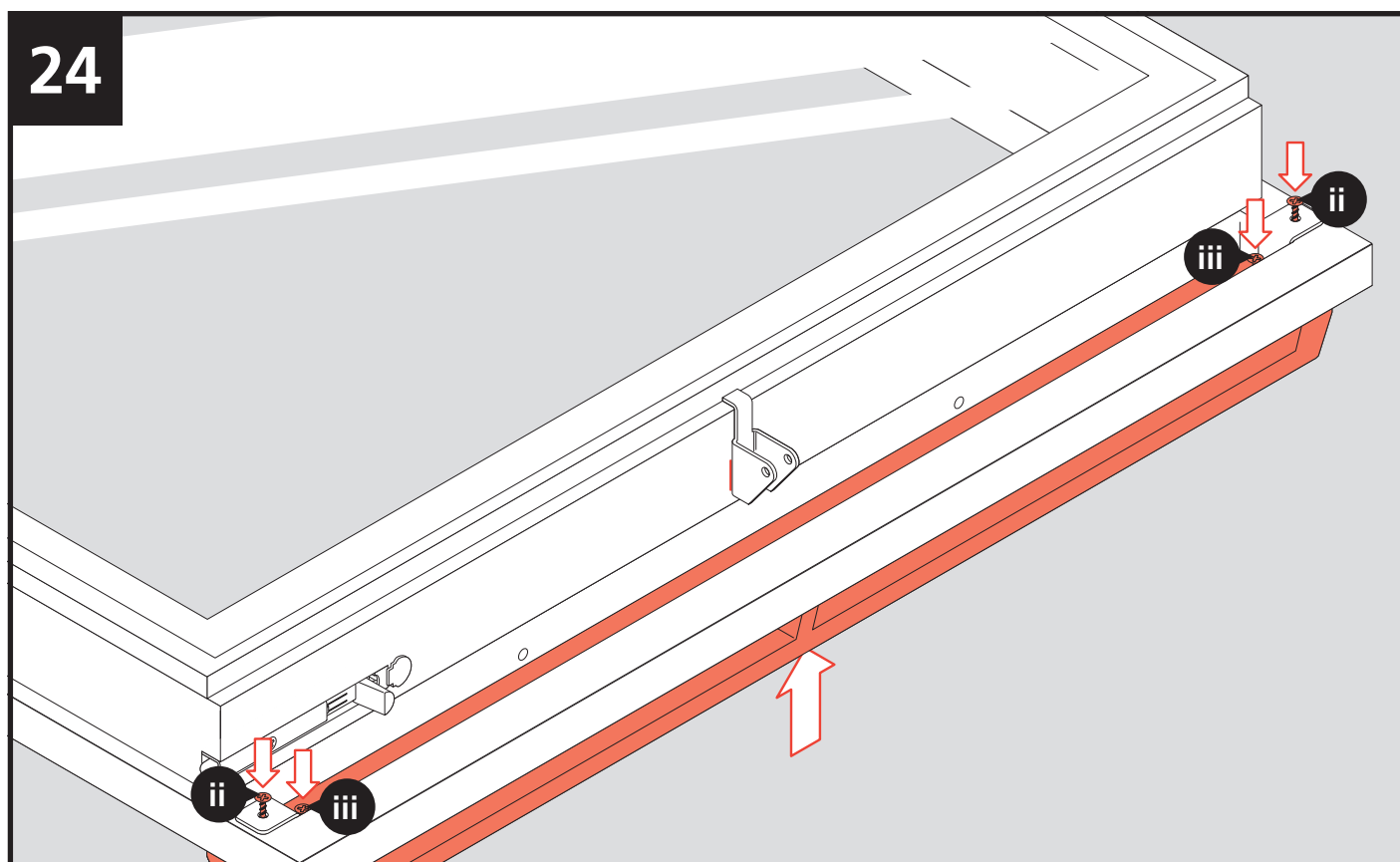
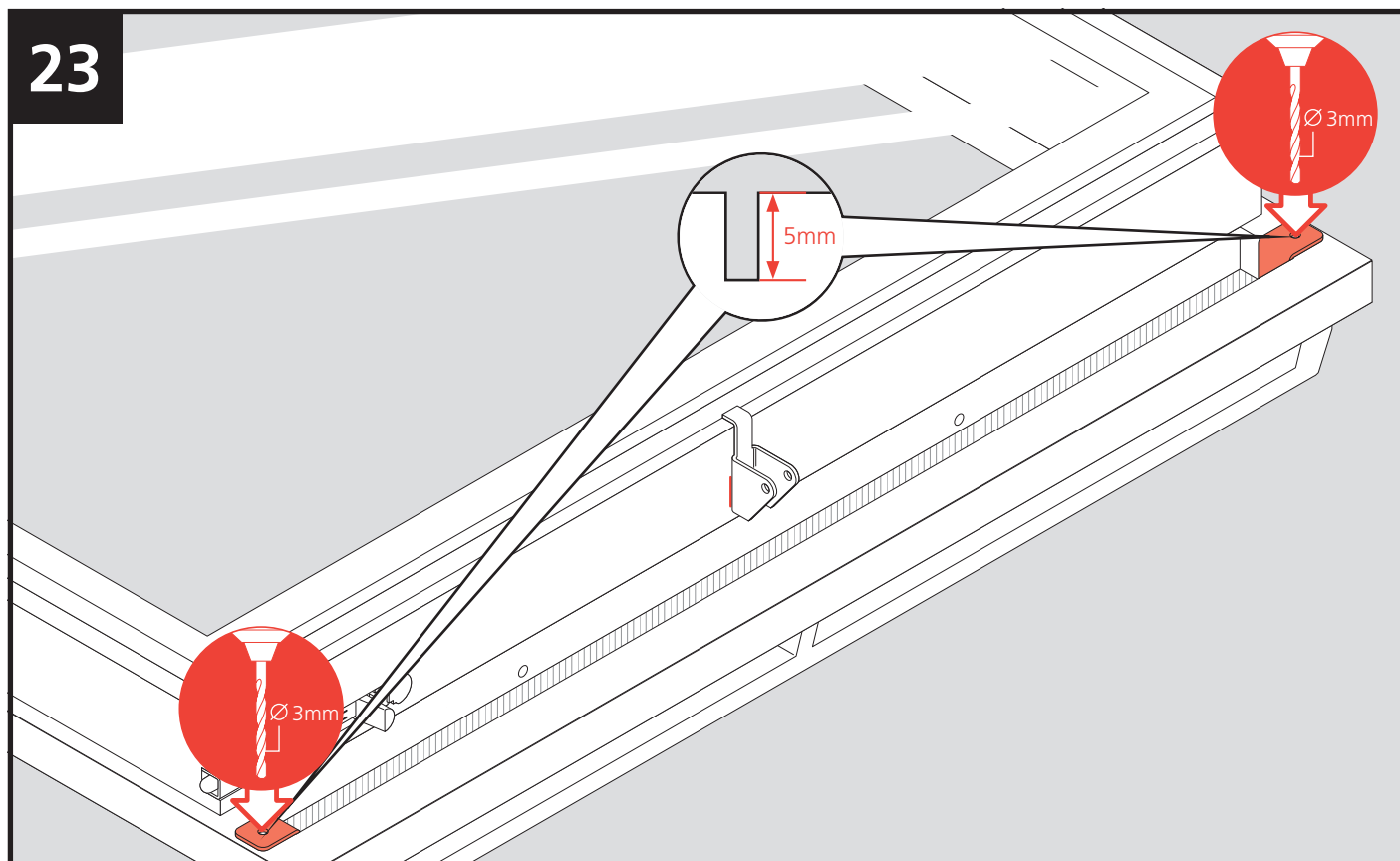

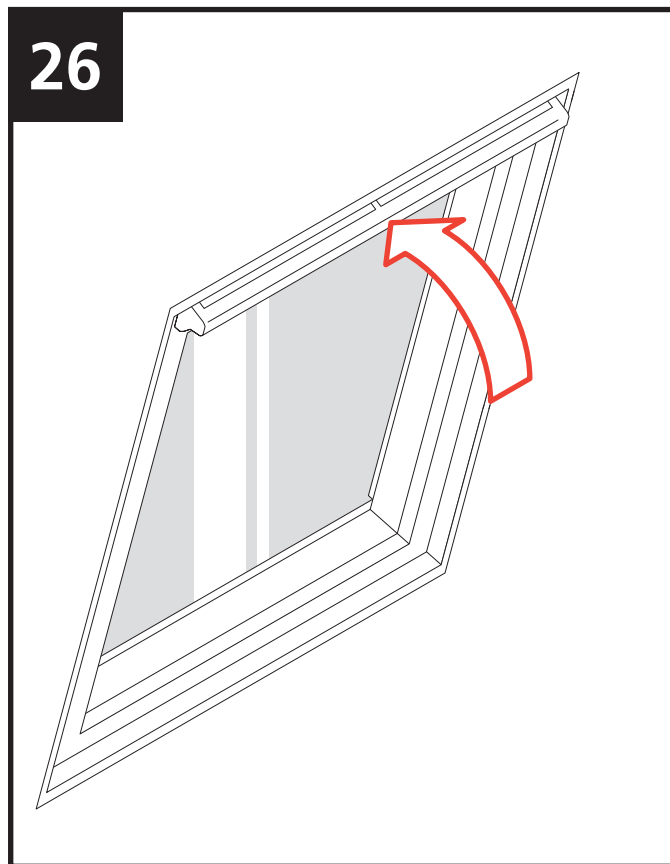
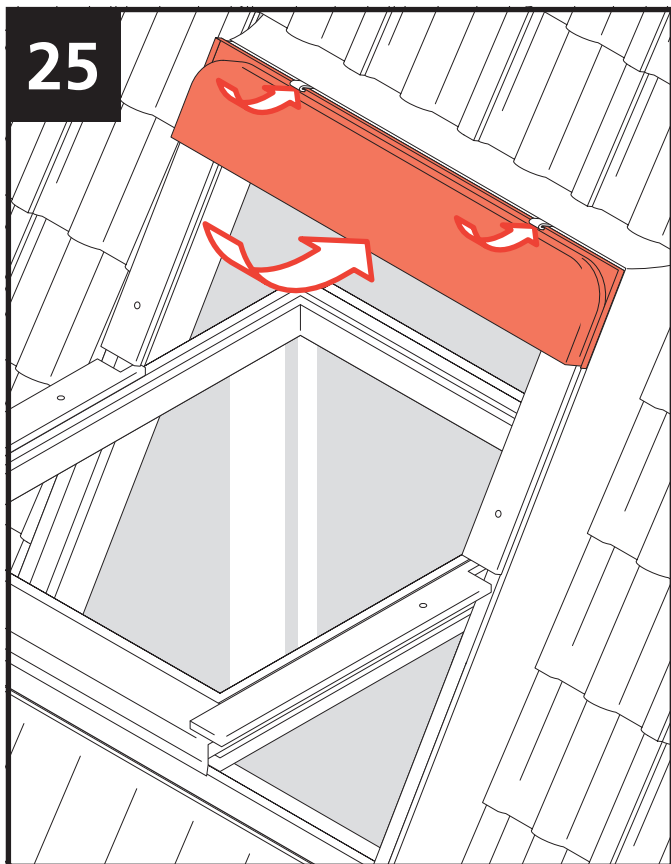

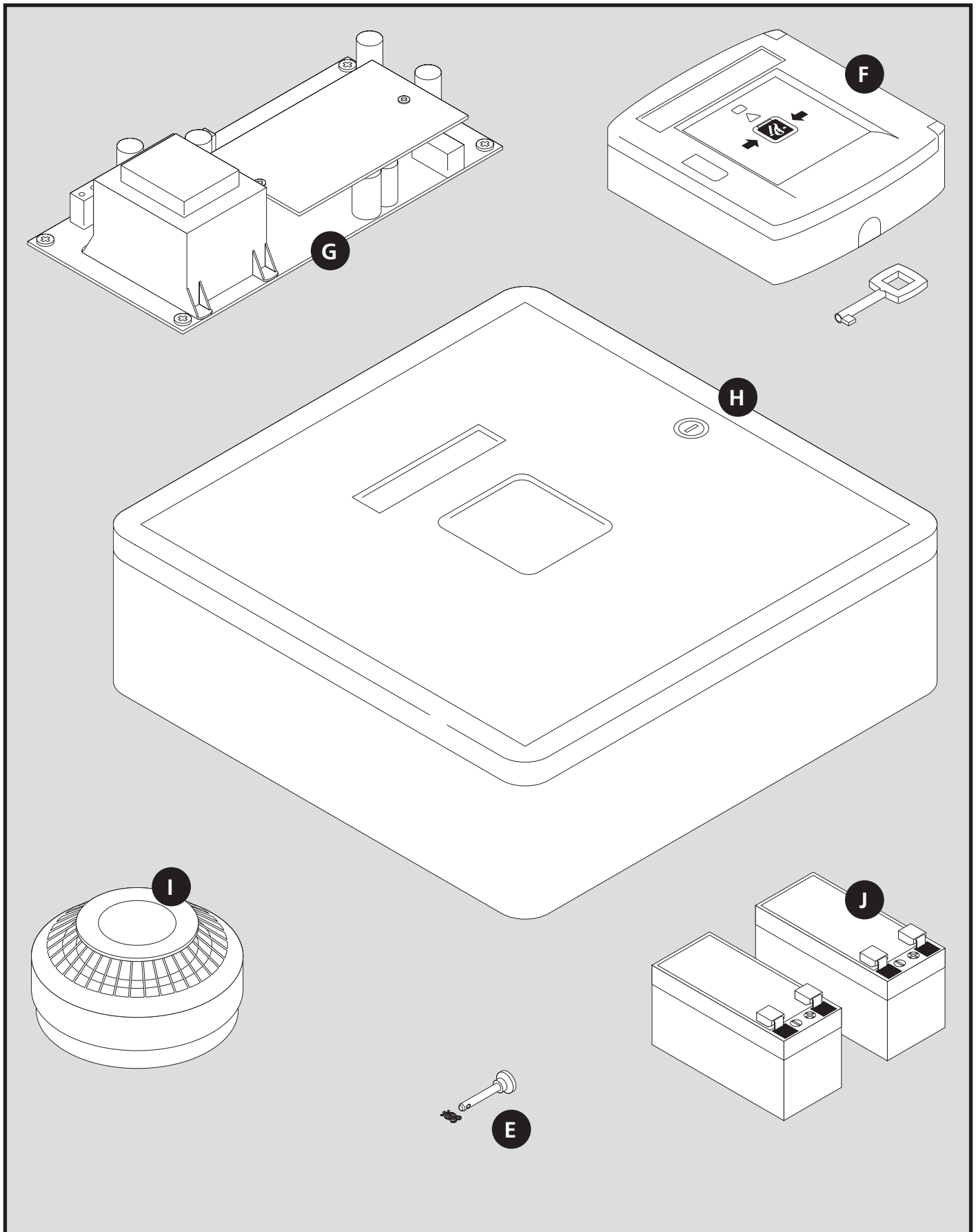



- Cables for RM/RT/MOT shown in **RED** MUST be of a fire resistant type.
- Terminal resistor MUST be fitted in junction box where the motor is connected.
- Ensure the Dip Switches are set as pictured below (1,2,3 OFF 4,5,6 ON 7,8,9 OFF 10 ON).
- Batteries MUST be connected AFTER the 230V mains is supplied to the panel.
- The green OK LED in the breakglass is lit when the system is functioning correctly.
- The yellow LED in the breakglass is lit and the green LED goes off when the system is in fault.
- The yellow LED flashes when the system requires servicing.
- The red LED in the breakglass is lit when the system is in fire mode.
- There is a spare fuse of each type located on the inside of the panel door.
- If a fire alarm interface is being used, the system cannot be reset or the vent closed UNTIL the fire alarm is reset first.
- If using a ventilation switch, it will NOT operate when the system is in fire mode, or in the event of a mains failure.

**1**

